



When Buying From Deso, You Are Buying More Than Products, You Are Buying Quality And Service

## ATV WINCH SERIES(DST2500)

### FEATURES:

- IP67 Motor And Gearbox
- Motor Can Rotate 90 Degree Easily, Meet Various Wiring And Mounting Demands
- Weather Resistance 250A High Performance Contactor, Long Life Span
- Patented Unique Automatic Spring Brake, Reliable In Full Load Operation
- Synthetic Rope And Aluminium Hawse As Optional

### PARAMETER:

- Single Line Rated Pull: 2500LBS(1135KG)
- Motor: Permanent Magnet 2.34HP/1.8KW(12DC)
- Gear Train: 3 Stage Planetary Gear
- Gear Ratio: 180:1
- Clutch: Sliding Ring Gear
- Braking Action: Mechanical Automatic Load Holding
- Fairlead: 4-Way Roller Fairlead
- Wire Rope: 3/16" x 45.9' (Φ 4.8MM x 14M)
- Drum Size: 1.73" x 3.15" (44MM x 80MM)
- Dimension: 12.95" x 4.44" x 4.76" (329MM x 113MM x 121MM)
- Bolt Pattern: 4.9" x 3" (124MM x 76.2MM)
- New Weight (Wire Rope Included): 26LBS (11.8KG)

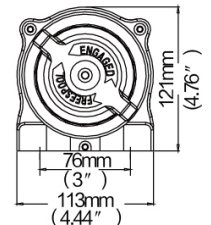
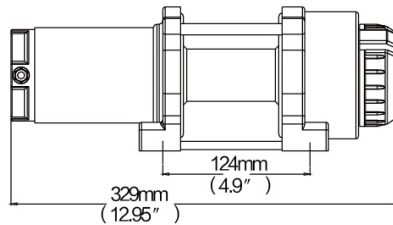

### 12V DC LINE SPEED AND MOTOR CURRENT (FIRST LAYER)

Line Pull		Line Speed		Motor Current (AMPS)
KG	LBS	MPM	FPM	
0	0	4.8	15.4	26
454	1000	3	9.8	60
680	1500	2.6	8.5	90
907	2000	2.3	7.5	115
1135	2500	1.6	5.2	150

### LINE PULL AND CABLE CAPACITY

Layer Of Cable	Rated Line Pull Per Layer		Cable Capacity Per Layer	
	KG	LBS	M	FT
1	1135	2500	2.4	7.9
2	922	2033	5.3	17.4
3	777	1713	8.6	28.2
4	671	1480	12.4	40.7
5	591	1303	14	45.9



When Buying From Deso, You Are Buying More Than Products, You Are Buying Quality And Service

## ATV WINCH SERIES(DST3500)

### FEATURES:

- IP67 Motor And Gearbox
- Motor Can Rotate 90 Degree Easily, Meet Various Wiring And Mounting Demands
- Weather Resistance 250A High Performance Contactor, Long Life Span
- Patented Unique Automatic Spring Brake, Reliable In Full Load Operation
- Synthetic Rope And Aluminium Hawse As Optional

### PARAMETER:

- Single Line Rated Pull: 3500LBS(1589KG)
- Motor: Permanent Magnet 2.86HP/2.2KW(12DC)
- Gear Train: 3 Stage Planetary Gear
- Gear Ratio: 180:1
- Clutch: Sliding Ring Gear
- Braking Action: Mechanical Automatic Load Holding
- Fairlead: 4-Way Roller Fairlead
- Wire Rope: 13/64"×45' (Φ 5MM×13.7M)
- Drum Size: 1.73"×3.15" (44MM×80MM)
- Dimension: 13.1"×4.44"×4.76" (334MM×113MM×121MM)
- Bolt Pattern: 4.9"×3" (124MM×76.2MM)
- New Weight (Wire Rope Included): 26.4LBS(12KG)

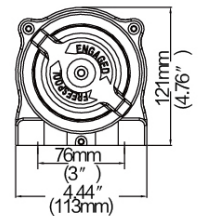
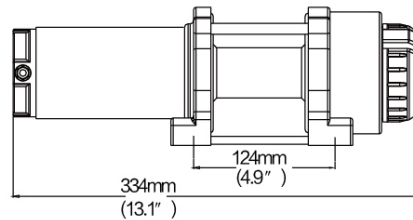

### 12V DC LINE SPEED AND MOTOR CURRENT(FIRST LAYER)

Line Pull		Line Speed		Motor Current (AMPS)
KG	LBS	MPM	FPM	
0	0	5	16	26
454	1000	3.5	11.5	65
680	1500	3.3	10.8	95
1135	2500	2.7	8.9	110
1589	3500	1.8	5.9	185

### LINE PULL AND CABLE CAPACITY

Layer Of Cable	Rated Line Pull Per Layer		Cable Capacity Per Layer	
	KG	LBS	M	FT
1	1589	3500	2.3	7.5
2	1319	2905	5.1	16.7
3	1128	2484	8.3	27.2
4	985	2169	12.1	39.7
5	874	1926	13.7	44.9



When Buying From Deso, You Are Buying More Than Products, You Are Buying Quality And Service

## ATV WINCH SERIES(DST4500)

### FEATURES:

- IP67 Motor And Gearbox
- Motor Can Rotate 90 Degree Easily, Meet Various Wiring And Mounting Demands
- Weather Resistance 250A High Performance Contactor, Long Life Span
- Patented Unique Automatic Spring Brake, Reliable In Full Load Operation
- Synthetic Rope And Aluminium Hawse As Optional

### PARAMETER:

- Single Line Rated Pull: 4500LBS(2043KG)
- Motor: Permanent Magnet 3.25HP/2.5KW(12DC)
- Gear Train: 3 Stage Planetary Gear
- Gear Ratio: 180:1
- Clutch: Sliding Ring Gear
- Braking Action: Mechanical Automatic Load Holding
- Fairlead: 4-Way Roller Fairlead
- Wire Rope: 7/32"×55.8' (Φ 5.4MM×17M)
- Drum Size: 1.73"×4.86" (44MM×123.5MM)
- Dimension: 14.88"×4.44"×4.76" (386MM×113MM×121MM)
- Bolt Pattern: 6.6"×3" (168MM×76.2MM)
- New Weight (Wire Rope Included): 30.6LBS(13.9KG)

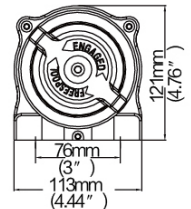
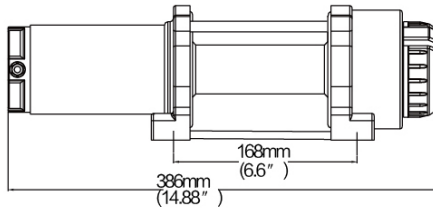
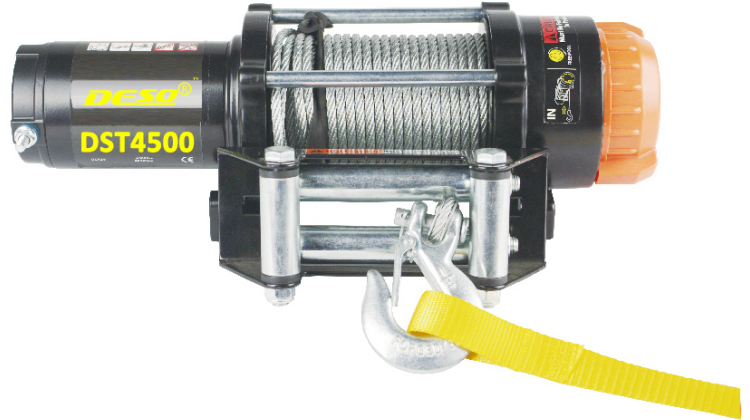

### 12V DC LINE SPEED AND MOTOR CURRENT(FIRST LAYER)

Line Pull		Line Speed		Motor Current (AMPS)
KG	LBS	MPM	FPM	
0	0	4.5	14.5	30
680	1500	3.0	9.8	76
1135	2500	2.5	8.2	105
1589	3500	2.0	6.6	135
2043	4500	1.3	4.3	185

### LINE PULL AND CABLE CAPACITY

Layer Of Cable	Rated Line Pull Per Layer		Cable Capacity Per Layer	
	KG	LBS	M	FT
1	2043	4500	3.5	11.5
2	1676	3691	7.8	25.6
3	1421	3129	12.9	42.3
4	1233	2715	17	55.8